



## Luxlink<sup>®</sup> DALI Multi-Sensor

Part Number – Link/DaliMS

The Luxlink DALI Multi-Sensor is a compact device containing Passive Infra-Red Detector, Light Sensor and Active Infra-Red Receiver elements to provide a wide array of sensor functional profiles. These include presence/absence sensing, constant light and IR control for automated, semi-automated and comfort control for energy savings and the full utilisation of the installed lighting scheme that includes DALI HF ballasts and load interface units

The sensor offers the full Luxlink DALI functionality options to include On, Off, "Go To Scene", "Touch" control for push-to-make switching & dimming and much more. This sensor is suitable for use with DALI HF ballasts and Load Interface Units designed to DALI open standard protocol. The sensor can be mounted in luminaire or in a ceiling tile

### Product Features and Connectivity:

- Small, compact design, 27mm deep (52mm with shroud)
- Three separate elements that can be individually enabled
- 20 Second walk-test feature
- Programmable using Luxlink DALI Software
- Suitable for the connection of a push-to make switch for absence switching, lighting override and "Touch" control
- Can be supplied with cable and plug for connection to Luxonic modular wiring system
- A co-operative sensor for communication with other same group sensors in open plan applications
- Intermediate dim level prior to off or programmable for "off to dim" for call centre type applications
- Suitable for used with the Luxlink DALI IR Controller



### Installation Notes:

- All cabling must be rated at 230V

### Application:

This sensor is ideal for use as part of Luxlink DALI Lighting Management System in projects where automated, comfort and/or IR control of lighting is required. Ideally suited for projects where the building owner/occupier requires the ability to reconfigure the system according to their changing environment without 3<sup>rd</sup> party commissioning

All Luxlink DALI field control devices are available with cable and modular wiring plug system assembly for network connection at the nearest Luxonic Luminaire when a Luxlink DALI modular wiring system is being installed

### Family Products (Network based):

Link/DaliCC/10	Luxlink DALI Connectivity Centre
Link/DaliCM/2/S	Luxlink DALI Connectivity Module Dual Feed Slave
Link/DaliSSMK2	Luxlink DALI Switching-Sensor
Link/DaliIRC	Luxlink DALI IR Controller
Link/DaliMIU	Luxlink DALI Mini Input Unit
Link/DaliSP	Luxlink DALI Scene Panel, 4-Scene

Data subject to change without notice, E & OE, Revision G – 08/06/2016



## Luxlink<sup>®</sup> DALI Multi-Sensor

### Part Number – Link/DaliMS

#### Presence Detection Coverage

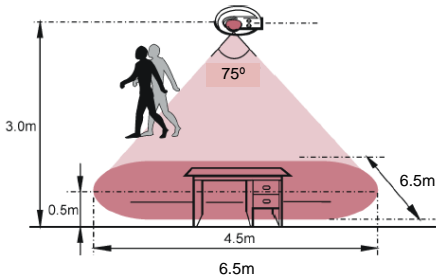

#### Constant Light Coverage with Restrictor

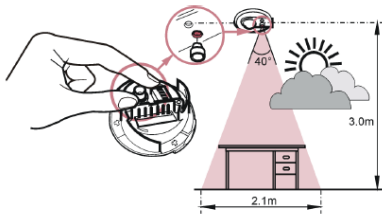

#### Constant Light Coverage without Restrictor

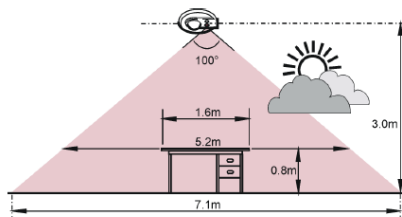

#### Dimensions

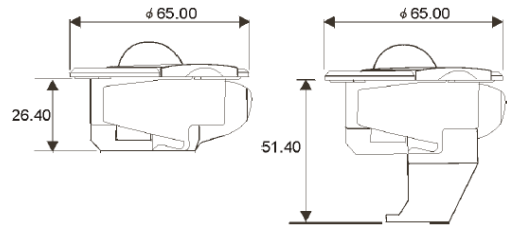

#### Installation

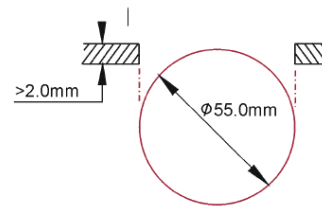
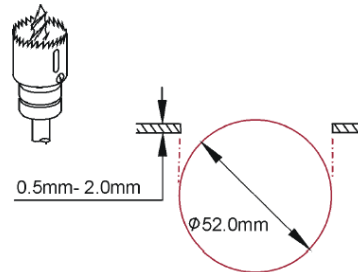

#### Connections

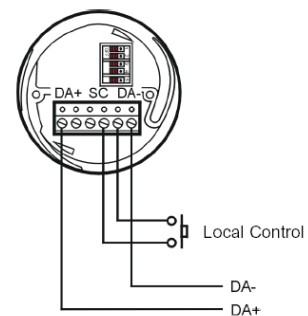

#### Technical Data

##### Connection

DALI: Standard Luxlink DALI removable connector with paired terminals 0.5mm<sup>2</sup> – 1.5mm<sup>2</sup> solid or stranded

Local Control: 2-wire 0.5mm<sup>2</sup> – 1.5mm<sup>2</sup> solid or stranded.  
50m Max Length

##### Power

DALI Supply: From DALI Power Supply Unit elsewhere in the system

DALI Consumption: 15mA

##### Operating Conditions

Ambient Temp: 0...50°C

Relative Humidity: 90% Max. non-condensing

Storage Temp: -10...+70 °C

##### Mechanical Data

Finish: Satin white plastic

Weight: 54g with shroud (48g without)

##### Conformity

EMC: Emission EN61547, Immunity EN55015

Safety: EN60950

IP Rating: IP20

Isolation: 4kV